

Un SIG OpenSource complet, autour de PostGIS 3D.

**Olivier Courtin & Hugo Mercier
Oslandia**

Projet e-PLU



Direccte
ÎLE-DE-FRANCE

Direction régionale des entreprises,
de la concurrence, de la consommation,
du travail et de l'emploi





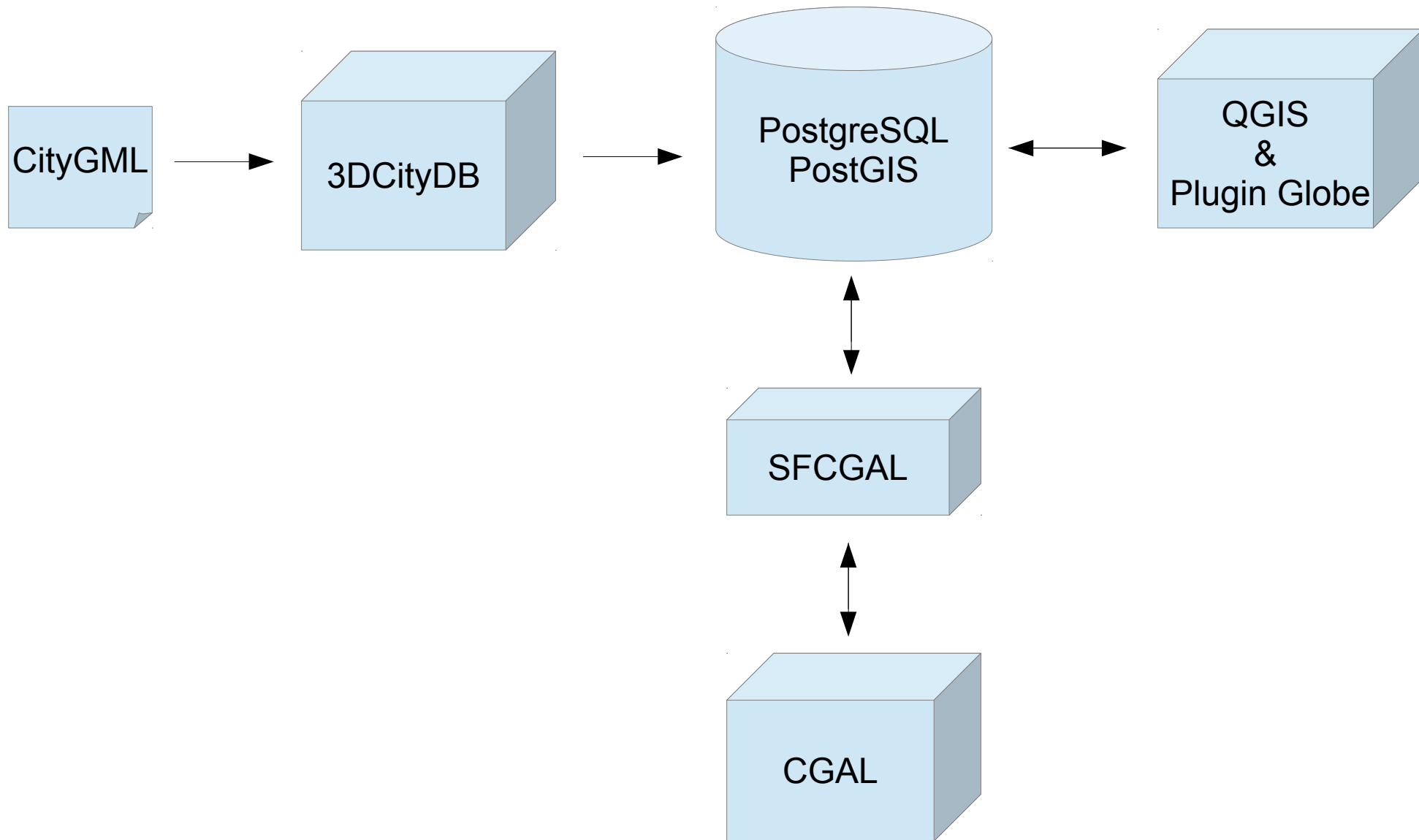

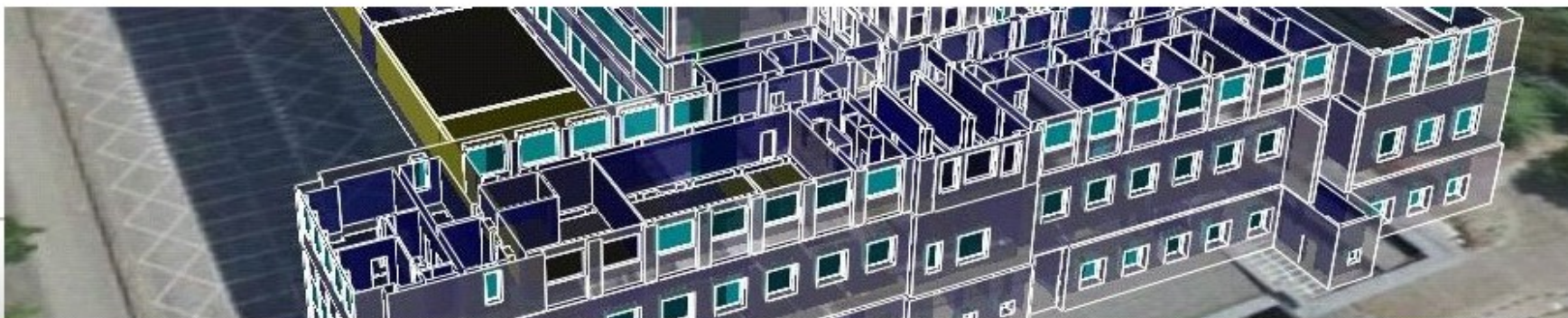

Download the 3D City Database

The package below contains the SQL scripts needed to create an Oracle Spatial database instance of the 3D City Database.

3DCityDB-2.0.6.zip (Version 2.0.6 | Oracle only | 163 KB)

Remarks

The 3D City Database requires access to a working installation of one of the Oracle Spatial DBMSs of version 10g R2, 11g R1, and 11g R2. The installation of all available patches from Oracle is highly recommended for optimal stability and performance. For Oracle 10g R2, at least patch set 10.2.0.4.0 is required for using the Matching/Merging plugin or the KML/COLLADA export capabilities. For detailed information consult the [Documentation](#).

Download the 3D City Database for PostGIS

The package below contains the SQL scripts needed to create a PostGIS database instance of the 3D City Database.

3DCityDB-2.0.6-postgis.zip (Version 2.0.6 | PostGIS only | 101 KB)

Downloads

[Documentation](#)
[3D City Database](#)
[Importer/Exporter](#)
[Importer/Exporter Plugins](#)
[citygml4j](#)

Software Licensing

Our software is open source and released under the terms of [LGPL](#).



Software Project Page

Visit our [Software Project Page](#) for details, further material, the SVN repository, etc. Get access to the Wiki, and report bugs.



CGAL

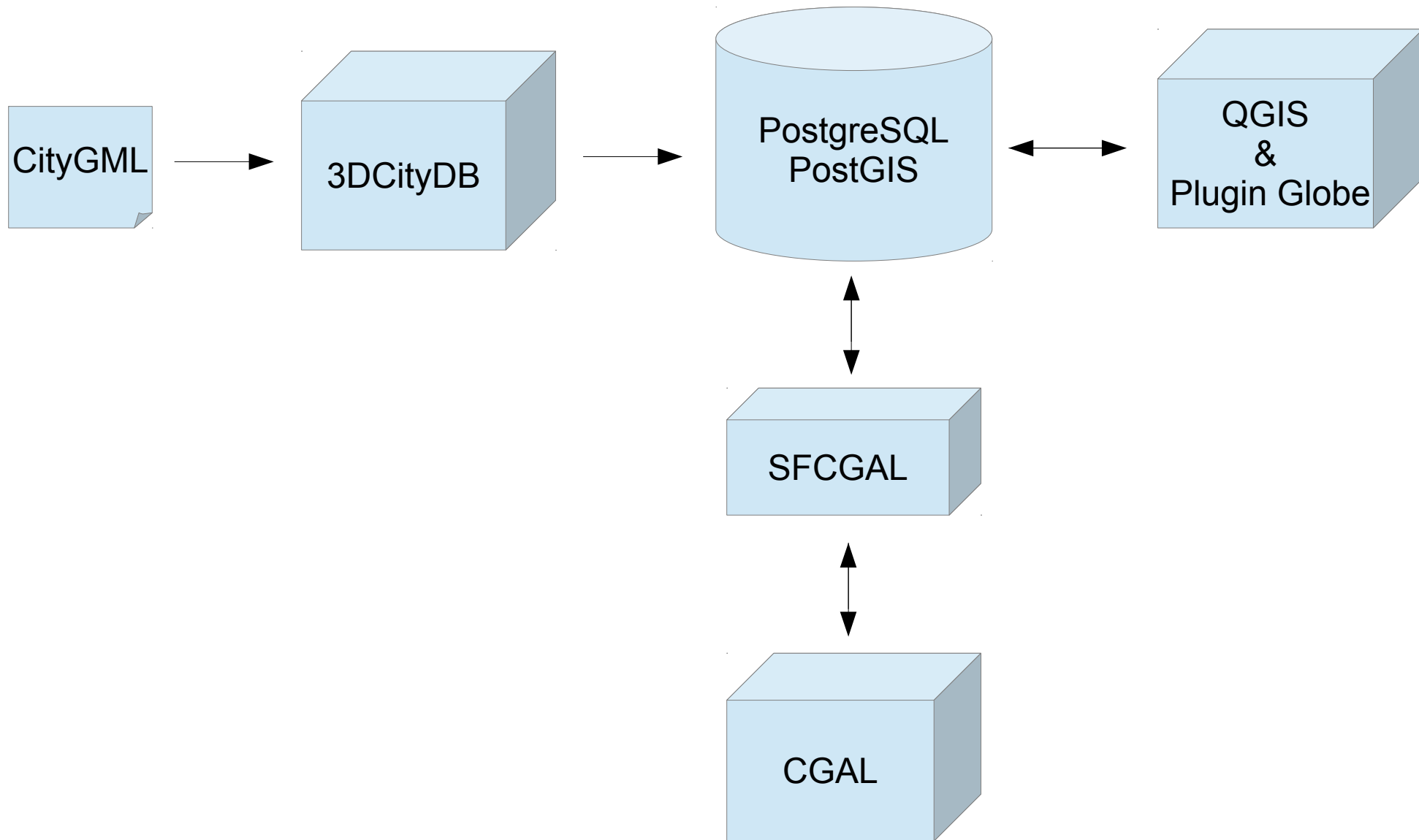

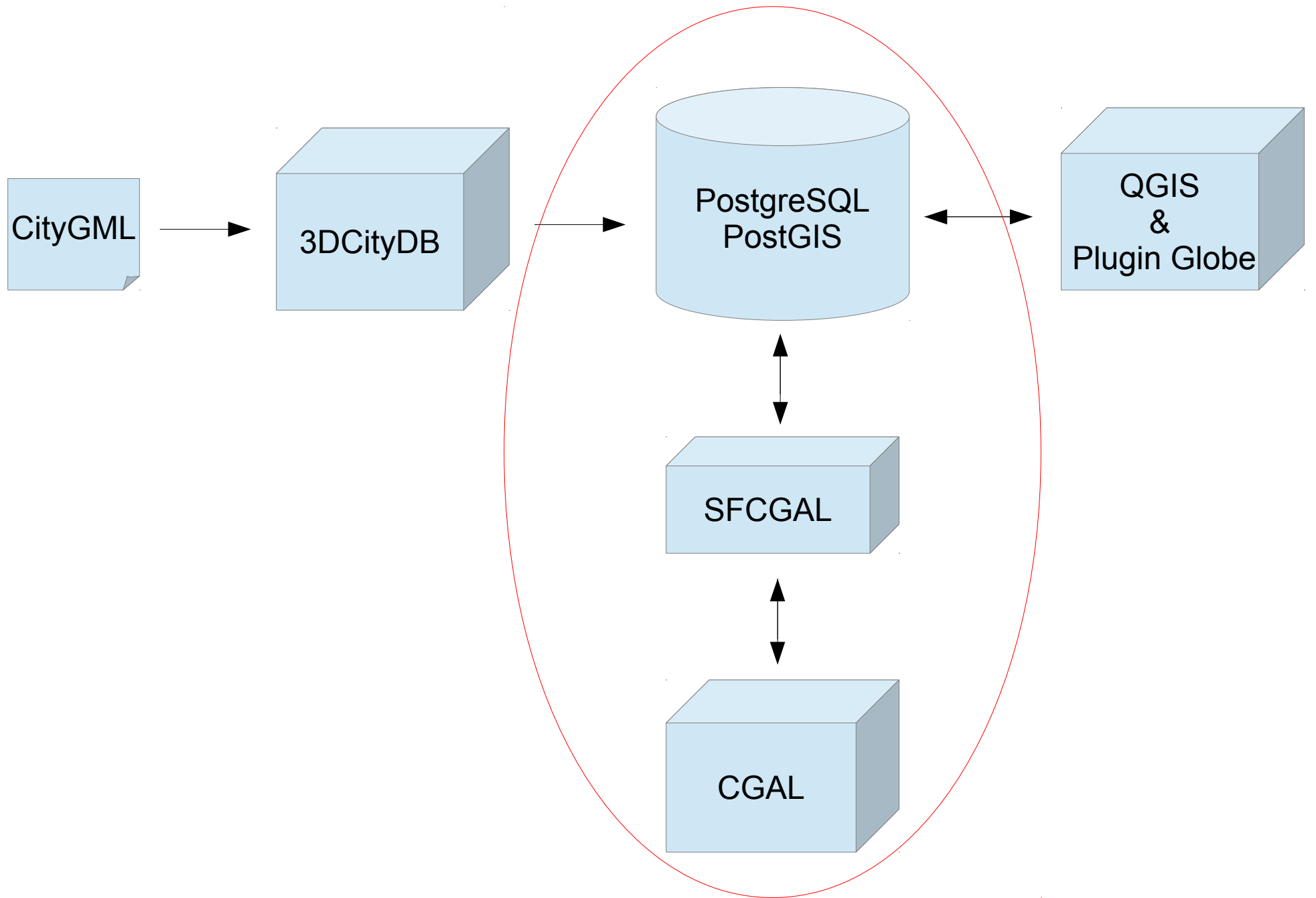

ST_3DIntersection

ST_Tessellate

ST_3DArea

ST_Extrude

ST_ForceLHR

ST_Orientation

ST_MinkowskiSum

ST_StraightSkeleton

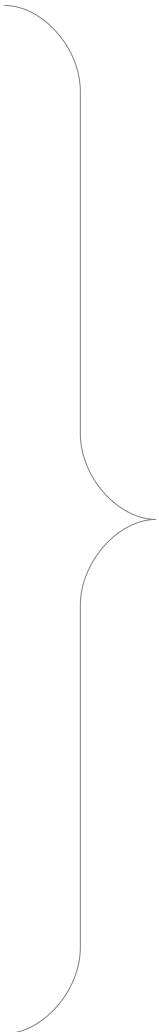

Fonctions spécifiques
SFCGAL

ST_Intersects

ST_3DIntersects

ST_Intersection

ST_Area

ST_Distance

ST_3DDistance



Fonctions communes
GEOS et SFCGAL

```
SET postgis.backend = 'geos' ;
```

```
SET postgis.backend = 'sfcgal' ;
```

Robustesse

Regress tests PostGIS pour GEOS OK

GardenTest PostGIS OK

Géométries invalides 3D en cours

Performances

En 2D de l'ordre de celle de GEOS
(gain de la précision arbitraire)

ST_Tessellate

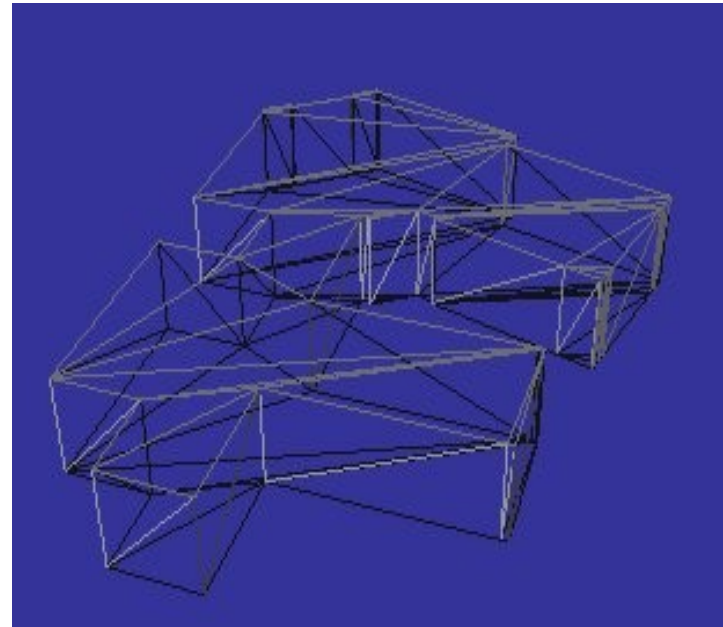
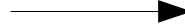
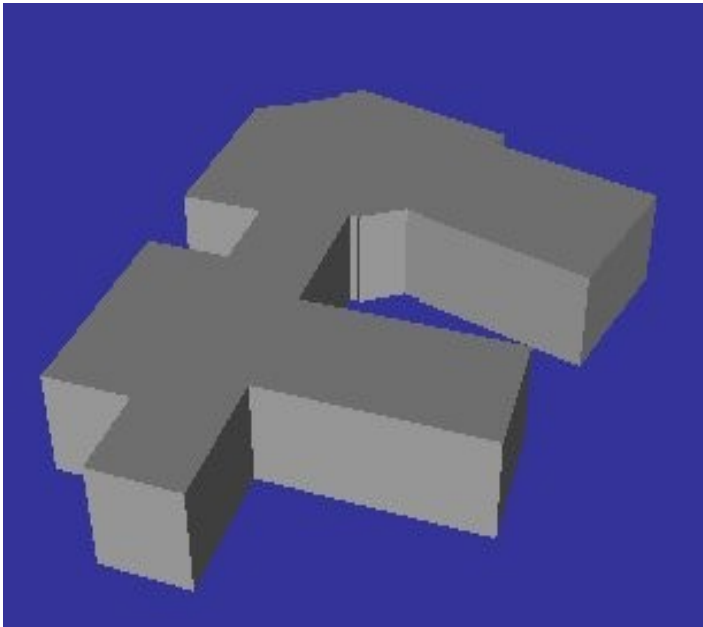

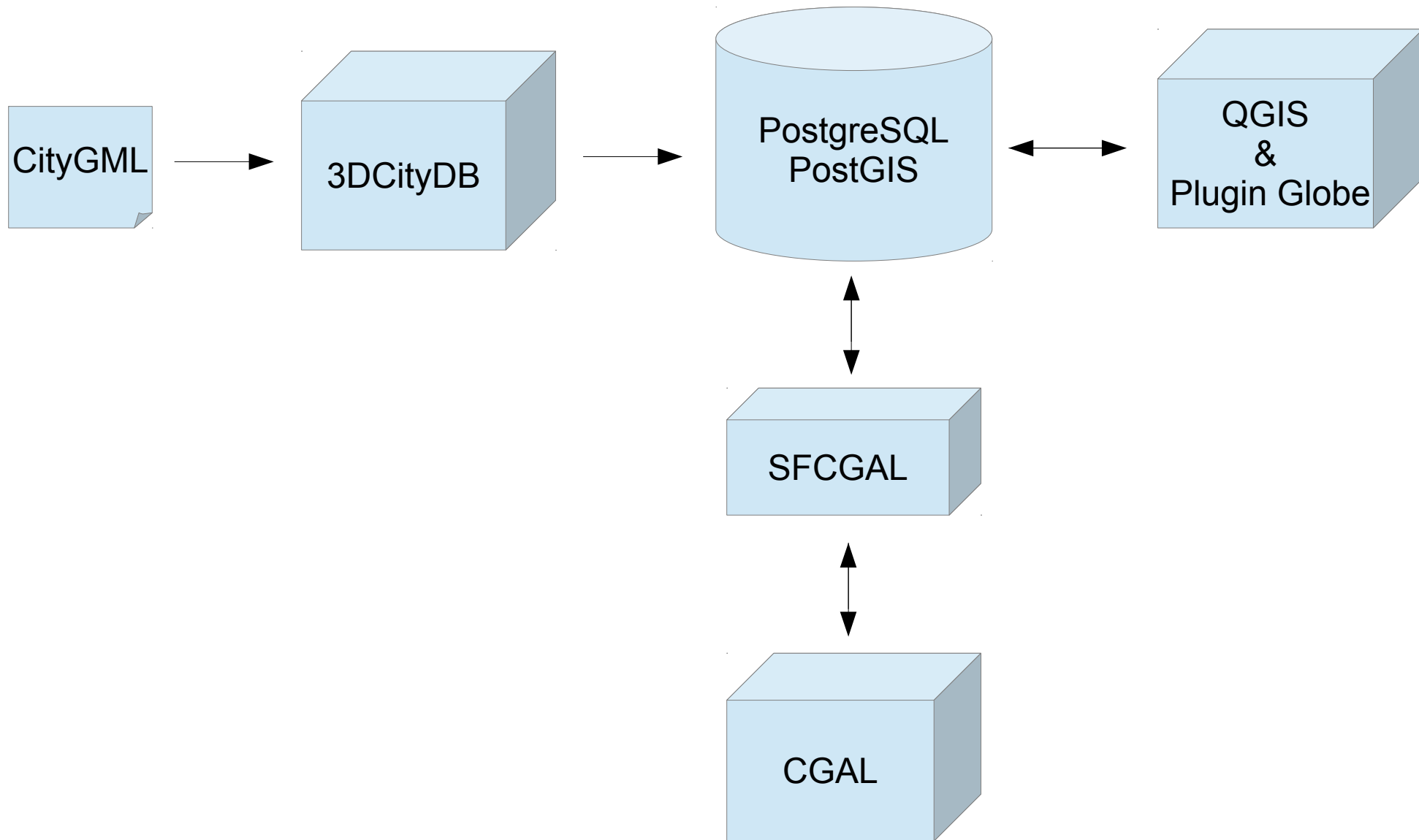



2012

2013

2014

Vidéo

<http://vimeo.com/54776907>



2012

2013

2014

ST_StraightSkeleton

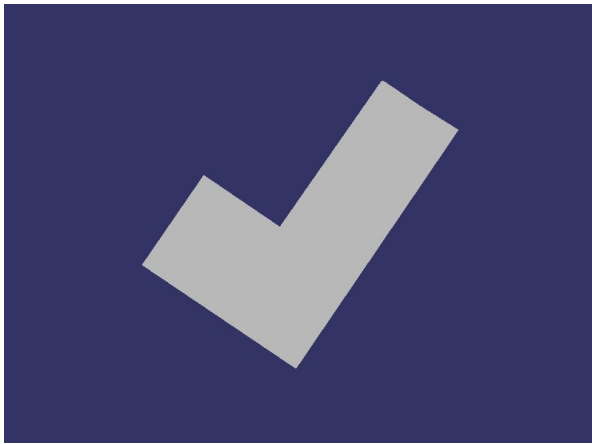

BATI 2D



Straight Skeleton

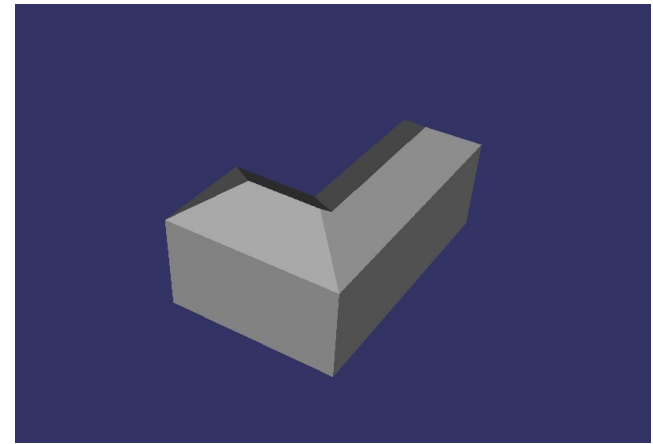

Extrusion & toit

PostGIS 2.1

www.postgis.org

SFCGAL

www.sfcgal.org

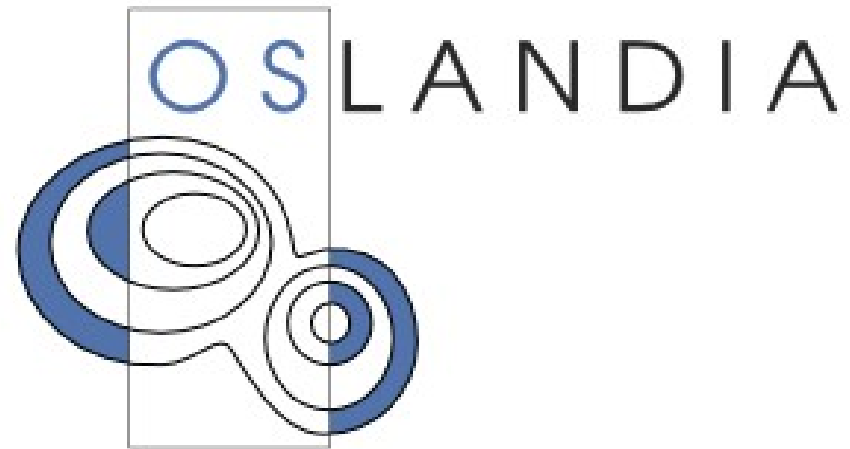

www.oslandia.com